

水戸市見川町字市毛山地内

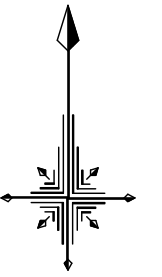

縮尺 1/500

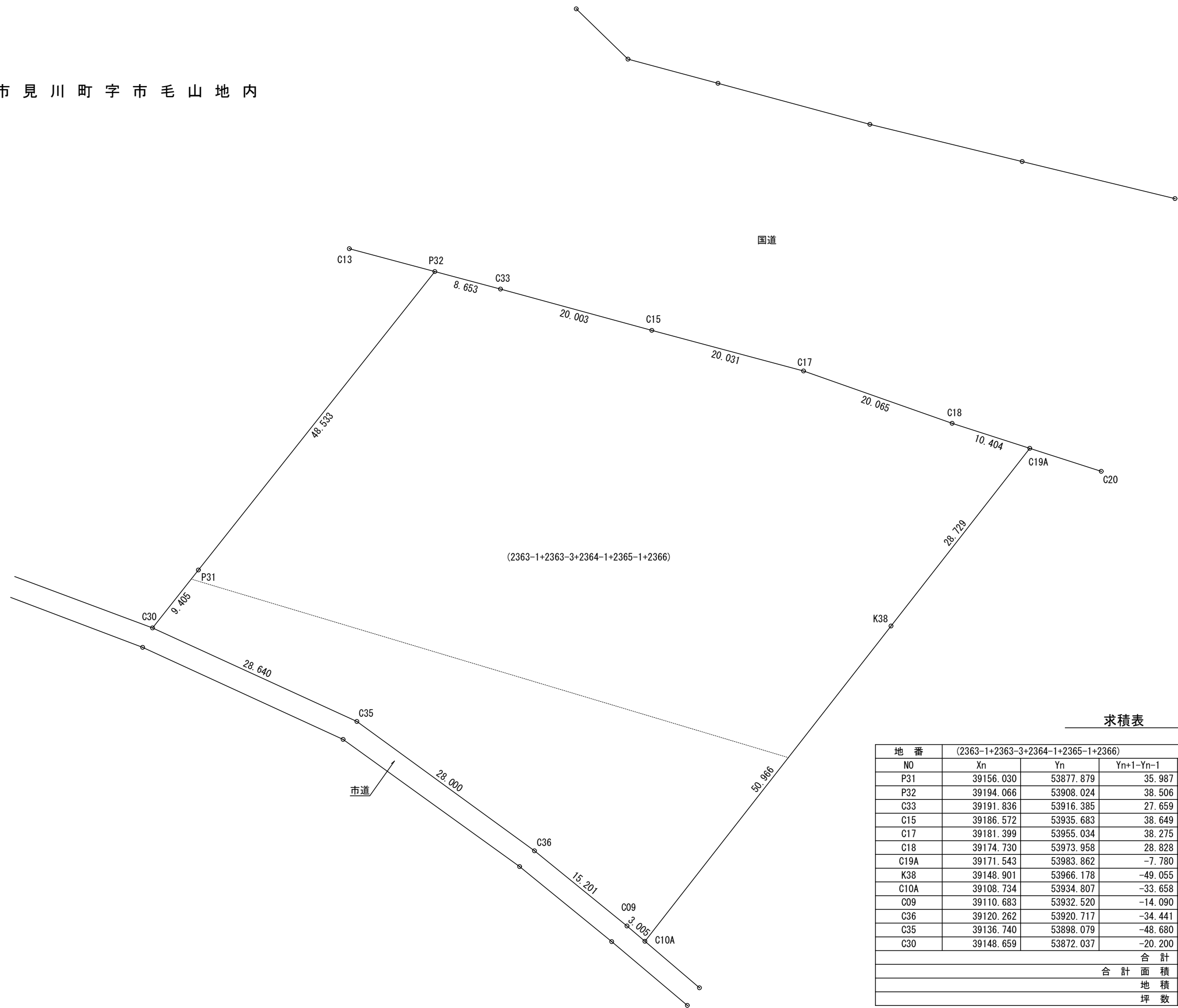

求積表

(2363-1+2363-3+2364-1+2365-1+2366)					
地番	Xn	Yn	Yn+1-Yn-1	Xn · (Yn+1-Yn-1)	辺長
P31	39156.030	53877.879	35.987	1409108.051610	48.533
P32	39194.066	53908.024	38.506	1509206.705396	8.653
C33	39191.836	53916.385	27.659	1084006.991924	20.003
C15	39186.572	53935.683	38.649	1514521.821228	20.031
C17	39181.399	53955.034	38.275	1499668.046725	20.065
C18	39174.730	53973.958	28.828	1129329.116440	10.404
C19A	39171.543	53983.862	-7.780	-304754.604540	28.729
K38	39148.901	53966.178	-49.055	-1920449.338555	50.966
C10A	39108.734	53934.807	-33.658	-1316321.768972	3.005
C09	39110.683	53932.520	-14.090	-551069.523470	15.201
C36	39120.262	53920.717	-34.441	-1347340.943542	28.000
C35	39136.740	53898.079	-48.680	-1905176.503200	28.640
C30	39148.659	53872.037	-20.200	-790802.911800	9.405
合計				9925.139244	
合計面積				4962.5696220	
地積				4962.56	m ²
坪数				1501.17	坪